

PRODUCT DATASHEET

LN INV CORNER CONNECTOR WT

LINEAR INDIVILED CORNER CONNECTOR | Mechanical and electrical connector for light line installation between luminaires



Product benefits

- Easy and quick connection of luminaires for light line installations
- Very solid connector for long operation

Product features

- Mechanical and electric connector (profile, 5 x 2.5 mm² internal wiring and terminal plug, male-female AC plug)
- Connector made of aluminum, white powder-coated
- Available in black and white color



TECHNICAL DATA

Dimensions & Weight

Length	350 mm
Width	350 mm
Height	43 mm
Product weight	1120.00 g

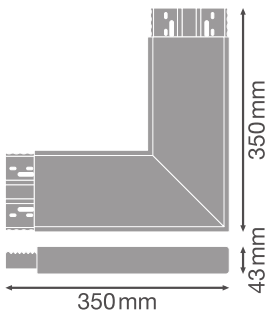

LN INV CORNER CONNECTOR WT

Materials & Colors

Product color	White
Body material	Steel



Application & Mounting





Replaceable light source	Yes
--------------------------	-----

Certificates & Standards

Standards	CE / UKCA
Luminaire with limited surface temperature, "D sign"	No

DOWNLOAD DATA

Documents and certificates		Document name
	User instruction / safety instructions	LN INV accessories
	Legal information	Safety Insert G11218828

Documents and certificates		Document name
	Legal information	Informationstext 18 Abs 4 ElektroG
	Legal information	LN INV Accessories
	Declarations of conformity	LN INV
	Declarations of conformity UKCA	LN INV

LOGISTICAL DATA

Product code	Packaging unit (Pieces/Unit)	Dimensions (length x width x height)	Gross weight	Volume
4099854308093	Folding box 1	404 mm x 404 mm x 142 mm	1342.00 g	23.18 dm ³
4099854308109	Shipping box 4	597 mm x 427 mm x 434 mm	6622.00 g	110.63 dm ³

The mentioned product code describes the smallest quantity unit which can be ordered. One shipping unit can contain one or more single products. When placing an order, for the quantity please enter single or multiples of a shipping unit.

ADDITIONAL CATALOG INFORMATION

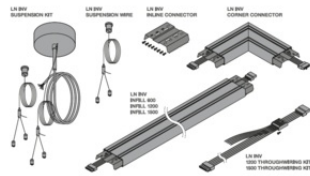

DISCLAIMER

Subject to change without notice. Errors and omission excepted. Always make sure to use the most recent release.